

## ▶ Comfortable segregating

A segregator bucket is a perfect attachment for excavator usage. Screening and separating was not so easy and productive before. Every machine driver can install this tool on site and start working immediately. This bucket range is maintenance friendly and very popular to demolition,



road-construction and recycling companies. The segregator bucket is like an ordinary riddle-bucket.

Two individually framed bar gratings are powered by a hydraulic motor, via an eccentric shaft, creating a reciprocating motion causing the under size materials to exit the bucket through the alternating bar spaces.

## ▶ Applications:

- Topsoil cleaning
- Cleaning of contaminated soils
- Brick cleaning
- Back filling of cable and pipelines
- Recycling of rubble
- Excavation of graveyards
- Loading of concrete crushers
- Cleaning of construction area's

**"By use on site, maximum profit is guaranteed!"**

## ▶ Segregator Bucket

### ▶ Sorting/Demolition Grab

### ▶ Scrap Shear

### ▶ Rotar Cleaner

### ▶ Hydraulic Breaker

### ▶ Tyne Re-handling Grab

### ▶ Crusher Bucket

### ▶ Pulverizer

### ▶ Combi Shear

### ▶ Steel Shear

### ▶ Rail Cutter



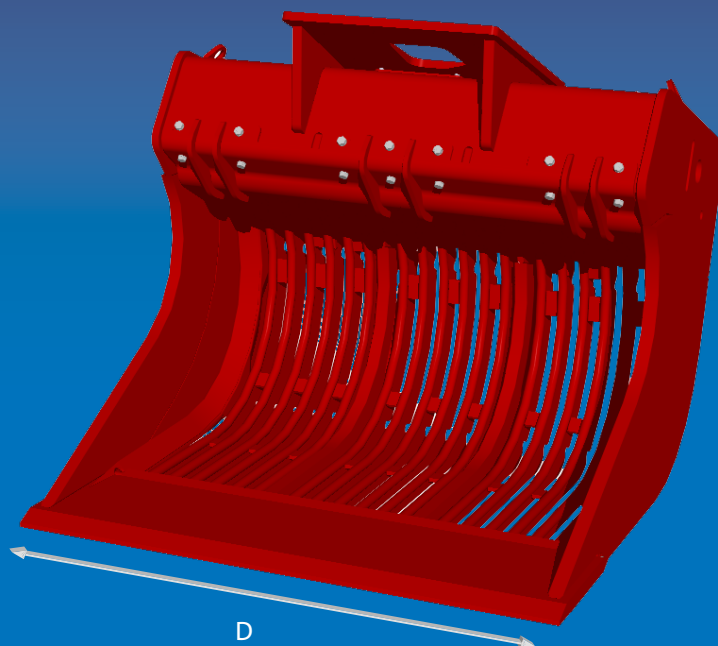
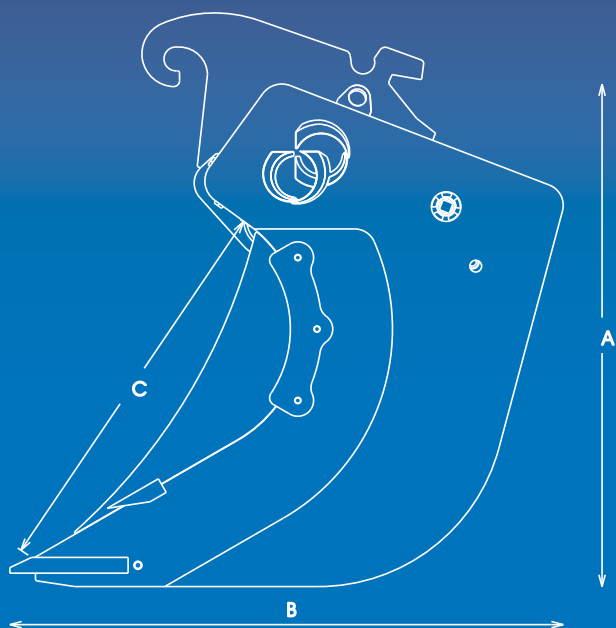

Type EVB	EVB 600 S	EVB 800 S	EVB 1200 S	EVB 1200 I
<b>Information</b>				
WEIGHT (KG) EXCL. ADAPTER	1100	1475	1885	1895
CAPACITY (L) CECE	600	800	1200	1200
MACHINE WEIGHT (T)	13-18	16-25	21-35	21-35
ROTAR HOLE-PATTERN	140-150	140-150	140-150	140-150
<b>Dimensions</b>				
DIMENSION A (MM)	1275	1275	1275	1295
DIMENSION B (MM)	1400	1400	1695	1720
DIMENSION C (MM)	1000	1000	1140	1140
DIMENSION D (MM)	1200	1560	1610	1610
<b>Hydraulic</b>				
MAX. OPERATION PRESSURE MOTOR (BAR)	140	140	140	140
MAX. OIL-FLOW MOTOR (L/MIN.)	70-100*	70-100*	70-100*	70-100*

\* Distance between bars S=42mm - l=80mm

\* System is controlled by a flowcontrol-valve

Specifications may change without prior notice

Optional:  
Teeth

*Your Attachment Supplier*